

INSTALLATION INSTRUCTIONS FOR 23" DIAMETER INDUSTRIAL REFLECTOR BL-OU60

WARNINGS:

- Install, operate, and maintain to meet all applicable codes.
- Handle and secure so reflector cannot fall.
- Lamp wattage and type installed must match that specified on the fixture label.
- Do not use open reflectors with lamps that require enclosures.

Please read thoroughly before installing

**A. TO ASSEMBLE 23" DIAMETER BL-OU60 REFLECTOR
FIGURE 1**

1. Remove the four brackets, screws, and adapter ring from the hardware bag accompanying the reflector.
2. Assemble the two reflector bracket assemblies (1). See mounting bracket assembly instructions.
3. Adjust movable bracket per distribution chart.
4. Place the adapter ring (2), with extruded holes down, on top of the reflector (3) and align the four mounting holes.
5. Using the four #8-32 x 1/2" screws (4), LOOSELY attach the adapter ring to the top of the reflector. Please note: The screw should come up through the inside of the reflector and into the extruded holes in the adapter ring.
6. Insert bracket assemblies into slots provided in the adapter ring. Tabs should point outward.
7. Completely tighten the four screws attaching the adapter ring to the reflector until the feet on the mounting brackets cannot move.

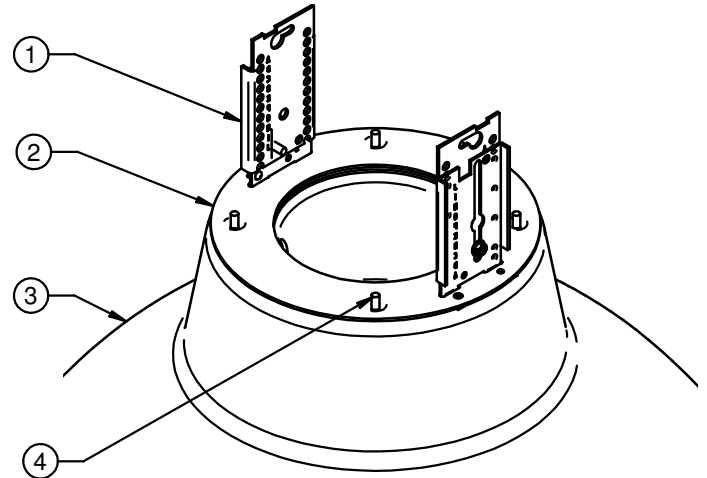
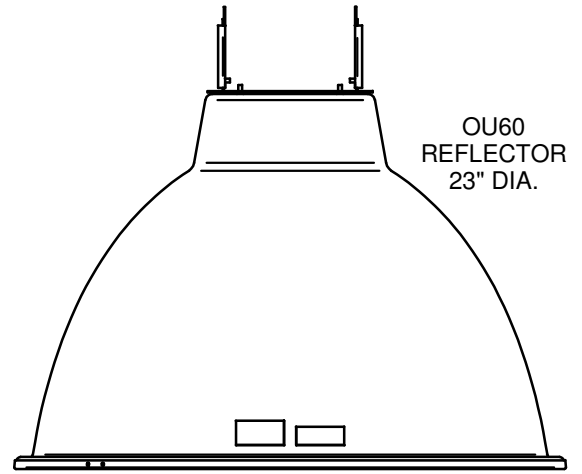

FIGURE 1

**B. TO INSTALL 23" DIAMETER BL-OU60 REFLECTOR
FIGURE 2**

1. Back off the two screws (5) in the lower side(s) of the ballast housing (6) about five turns each.
2. Raise the reflector up to the bottom of the ballast housing and guide it around the HID lamp socket (7).
3. Attach brackets, with key holes, to ballast housing and tighten screws on both sides.
4. Straighten both bracket pairs to align the optical assembly and to ensure that the HID lamp is centered within the reflector. Make sure everything is tightened for proper engagement and security.

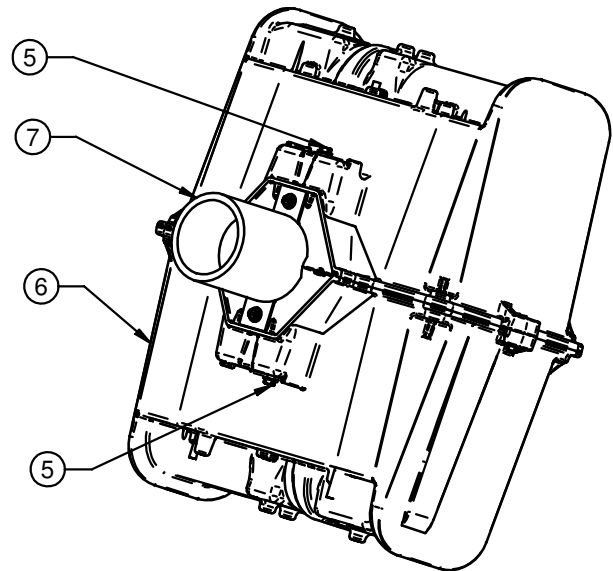

FIGURE 2

C. PHOTOMETRIC DISTRIBUTION AND BRACKET POSITION CHART

1. Bracket positions indicated by letter in chart.
2. Letter on upper bracket appears in indicator circle on lower sliding bracket.

REFLECTOR BRACKET SETTINGS					
REFLECTOR	LAMP WATTAGE	LAMP TYPE	LAMP POSITION SETTING		
			NARROW	MEDIUM	WIDE
BL-OU60	1000	MH	G	C	----
	1000	MH, PS	----	----	----
	1000	HPS	J	F	B



Industrial Lighting

Hubbell Lighting, Inc.
A subsidiary of Hubbell Incorporated
101 Corporate Drive, Suite L • Spartanburg, SC 29303

Doc. No. 93009175
Revision 09/06
Phone (864) 599-6000 Fax: (864) 699-1337

D. TO INSTALL 23" DIA. BL-OU60 REFLECTOR TO BALLAST HOUSING WITH QSS BRACKET ATTACHED FIGURES 3 & 4

1. Assemble reflector assembly per previous instructions.
2. Back off the two screws in the lower side(s) of the ballast housing about five turns each.
3. Raise reflector up towards the housing and allow the loose QSS bracket assembly (8) to pass through the central hole in the reflector.
4. Pass the QSS bracket assembly through the large hole in the side of the heat reflector (9).
5. Hold the cable close to HID socket and guide the reflector top over the cable and HID socket.
5. Attach brackets, with key holes, to ballast housing and tighten screws on both sides.
6. Straighten both bracket pairs to align the optical assembly and to ensure that the HID lamp is centered within the reflector. Make sure everything is tightened for proper engagement and security.
7. Install QSS bracket assembly by loosening the adapter ring screw (4) closest to the large hole in the heat reflector about five turns. Slide the bracket assembly under the screw head and tighten.
8. Orient bracket so that the auxiliary socket points down and slightly away from the main HID lamp.
9. **IMPORTANT NOTE:** Grasp the cable and carefully push any slack back through the slot in the HID socket. Make sure that the auxiliary cable does not contact the HID lamp.

E. INSTALL AUXILIARY (-QSS) LAMP IF APPLICABLE

1. A 120V double contact bayonet base incandescent or quartz incandescent lamp is required to fit into the auxiliary lamp socket (10).
2. Make sure the wattage of the auxiliary lamp is less than or equal to the wattage of the HID lamp. A nominal lamp that is recommended for use is the 150 watt, 120 volt D.C. bayonet base quartz lamp. (ANSI Code: ETC-120V).
3. Carefully place the auxiliary lamp in the socket at the end of the bent bracket provided (11). Hold the socket or socket bracket and push up and twist the lamp clockwise until it is seated correctly.
4. **IMPORTANT NOTE:** Wipe off any oily fingerprints on the lamp with a suitable glass cleaner. Oils from the skin can degrade the quartz lamp envelope when it is operated and result in lower light transmission and shorter lamp life.

F. ASSEMBLY INSTRUCTIONS FOR REFLECTOR MOUNTING BRACKETS

1. Place fixed bracket down with the side rails facing up.
2. Place movable bracket with two tabs facing up on top of the fixed bracket.
3. Install a retaining screw, supplied in the plastic hardware bag, through the slot in the movable bracket into the lower aligned hole in the fixed bracket.
4. Check the light distribution adjustment chart to find a proper setting for this movable bracket based upon the type and wattage of the light source and type of distribution required for installation.
5. Adjust the movable bracket to place the positional indicating letter, on either bracket, corresponding to a desired beam spread given on distributions wanted chart, in the indicating circle, on either bracket.
6. Tighten screw to secure setting.
7. Assemble the second bracket combination. See reflector installation instruction portion for installation and other information.

G. CLEANING

1. Clean inside of reflector with a mild non-abrasive soap or glass cleaner using a clean, soft cloth.

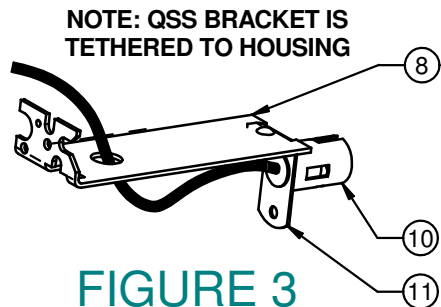

FIGURE 3

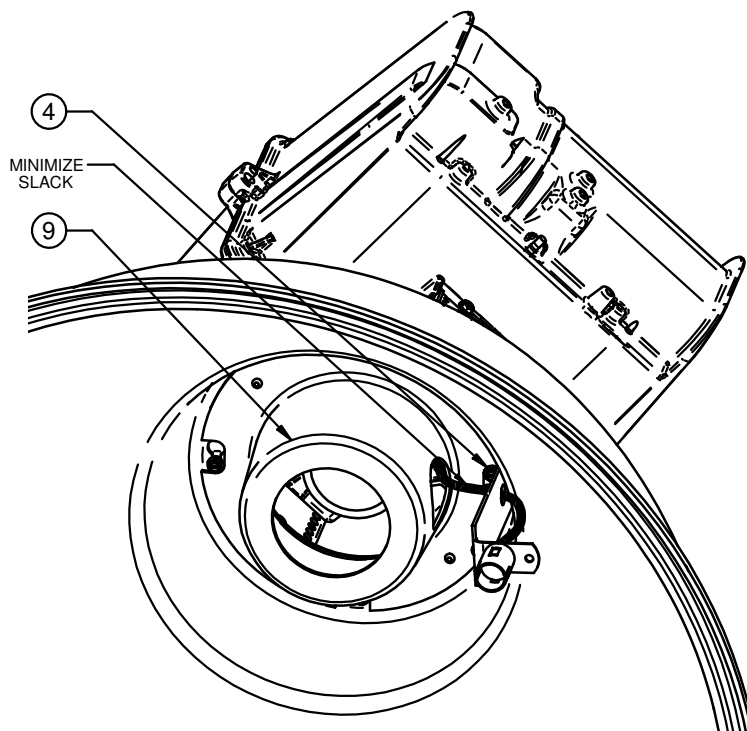
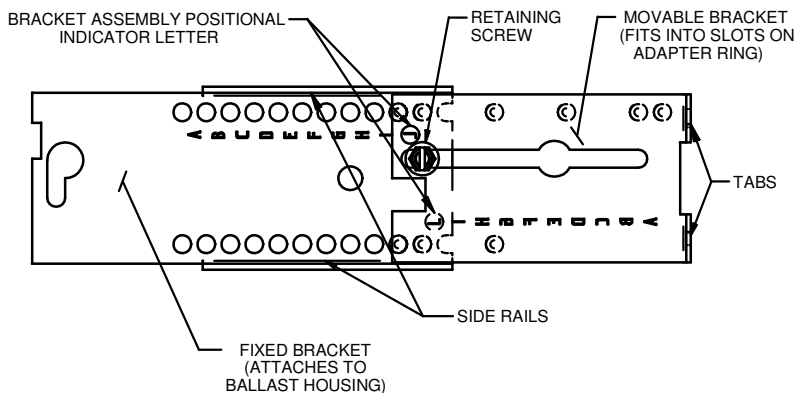

FIGURE 4



Industrial Lighting

Hubbell Lighting, Inc.
A subsidiary of Hubbell Incorporated
 101 Corporate Drive, Suite L • Spartanburg, SC 29303

Doc. No. 93009175
Revision 09/06
Phone (864) 599-6000 Fax: (864) 699-1337