

Cat. #		Approvals
Job	Type	

### APPLICATIONS

- For use in classified areas such as paint manufacturing, munitions facilities, chemical and petrochemical, oil & gas production, and marine loading terminals.

### SPECIFICATIONS

- Compact size for medium base incandescent and HID lamps, plus twin fluorescent (lamp provided).
- Mounting choices of pendant, ceiling, 25° stanchion or 90° wall mount with “wireless” design for quick installation.
- Factory sealed – no external seal required.
- Available with guard, standard dome or 25° reflector, or exit sign.
- Housing, Mounting adapter and Guard are copper-free (<0.4%) aluminum with powder polyester finish, electrostatically applied.
- Hardware is 316 stainless steel.
- Reflectors are fiberglass reinforced polyester.

### LISTINGS

- UL844 Standard: Class I, Division 1, Groups C, D; Class II, Div 1 & 2, Groups E, F, G; Class III, Division 1 & 2.
- UL1598A Marine Outdoor.
- NEMA 3, 4, 4X, 7 (C, D), 9 (E, F, G).
- UL1598 Wet Location.



### PENDANT

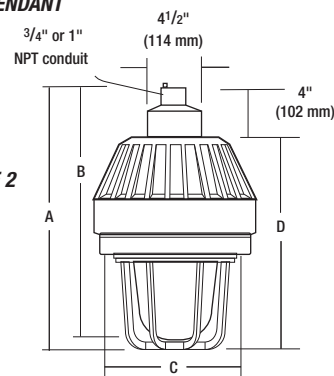

MORE DIMENSIONS ON PAGE 2

	A	B	C	D
<b>HLEMI / HLEBF</b>	14 <sup>5</sup> / <sub>16</sub> "	13 <sup>11</sup> / <sub>16</sub> "	77 <sup>1</sup> / <sub>16</sub> "	10 <sup>5</sup> / <sub>16</sub> "
	364 mm	348 mm	189 mm	262 mm
<b>HLEMH / HLEMM / HLEMS / HLESX</b>	15 <sup>15</sup> / <sub>16</sub> "	15 <sup>1</sup> / <sub>16</sub> "	81 <sup>3</sup> / <sub>16</sub> "	11 <sup>15</sup> / <sub>16</sub> "
	405 mm	383 mm	224 mm	303 mm

## ORDERING INFORMATION

ORDERING EXAMPLE: HLE-M-S-07-Q-A2-G

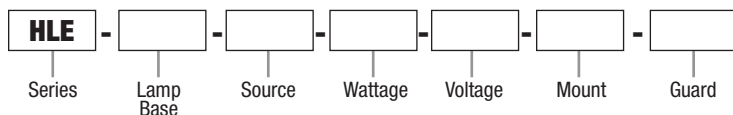

### SERIES

**HLE** HLE Series XP

### LAMP BASE

**M** Medium Base  
**B** Bi-Pin Base

### SOURCE

**I** Incandescent  
**F** Fluorescent  
**S** High Pressure Sodium  
**H** Metal Halide

### WATTAGE

**15** 150 watt A-21, INC  
**20** 300 watt PS-25, INC  
**30** 300 watt PS-30, INC  
**13** (1) 13 watt bi-pin FLUOR  
**26** (2) 13 watt bi-pin  
**35** 35 watt HPS  
**05** 50 watt HPS, MH, MV  
**07** 70 watt HPS, MH  
**75** 75 watt MV  
**10** 100 watt HPS, MH, MV  
**15** 150 watt HPS

### VOLTAGE (@ 60Hz)

**1** 120V  
**4** 277V  
**5** 480V  
**6** 347V Canada (70, 100 MH/HPS)  
**0** Quadri-Volt - 120/208/240/277V

### MOUNT

**A2** 3/4" Pendant  
**A3** 1" Pendant  
**X2** 3/4" Ceiling  
**X3** 1" Ceiling  
**B2** 3/4" Bracket  
**B3** 1" Bracket  
**D4** 11/4" Stanchion  
**D5** 11/2" Stanchion

### GUARD

**G** With Guard  
(Omit **G** if Guard is not required)

### OPTIONS

**ML** UL Marine listing for HLEMI  
Standard on HLEMS, HLEMM, HLEMH  
Not available on HLEBF, HLEQF  
**SU103** Assembled with Lamp

<sup>1</sup> Not available with incandescent

### ACCESSORIES

(order as separate part #)

Catalog Number	Description
<b>HLEMG1</b>	Guard for incandescent (PS-25) & fluorescent
<b>HLEMG2</b>	Guard for HID lamp sources & incandescent (PS-30)
<b>HLESD15</b>	Standard Dome Reflector for incandescent & fluorescent
<b>HLESD30</b>	Dome Reflector for HID lamp sources
<b>HLEA15</b>	Angle Reflector for incandescent & fluorescent
<b>ERA30</b>	Angle Reflector for HID lamp sources
<b>HLH-EX</b>	Triangular Exit Sign; fits HLEMI15, HLEMI20, HLEBF Series, without guard
<b>HLH-G</b>	Green Inner Globe Kit fits HLEMI20 (fits over A-21, 150W lamp only)
<b>HLH-R</b>	Red Inner Globe Kit fits HLEMI20 (fits over A-21, 150W lamp only)

### COMPONENTS

Catalog Number	Description	Catalog Number	Description
<b>MOUNTING ADAPTERS</b>		<b>HOUSING &amp; GLOBE</b>	
<b>HLEZA2</b>	3/4" Pendant	<b>HLEMI15</b>	150W max. Incandescent
<b>HLEZA3</b>	1" Pendant	<b>HLEMI20</b>	300W max. Incandescent (PS-25)
<b>HLEZB2</b>	3/4" Wall	<b>HLEMI30</b>	300W max. Incandescent (PS-30)
<b>HLEZB3</b>	1" Wall	<b>HLEBF13X<sup>1</sup></b>	1-13W PL Fluorescent
<b>HLEZD4</b>	11/4" Stanchion	<b>HLEBF26X<sup>1</sup></b>	2-13W PL Fluorescent
<b>HLEZD5</b>	11/2" Stanchion	<b>HLEMS070</b>	70W HPS Quad-Tap <sup>®</sup>
<b>HLEZX2</b>	3/4" Ceiling	<b>HLEMS100</b>	100W HPS Quad-Tap <sup>®</sup>
<b>HLEZX3</b>	1" Ceiling	<b>HLEMS151</b>	150W HPS 120V
		<b>HLEMH070</b>	70W MH Quad-Tap <sup>®</sup>
		<b>HLEMH100</b>	100W MH Quad-Tap <sup>®</sup>

<sup>1</sup> Replace **X** with **1**=120V, **4**=277V.

**DIMENSIONS**

**CEILING**

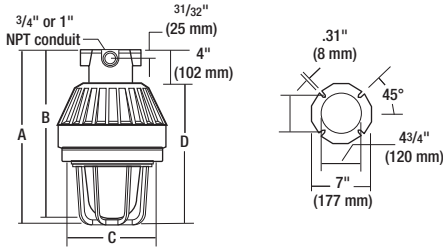

	<b>A</b>	<b>B</b>	<b>C</b>	<b>D</b>
<b>HLEMI / HLEBF</b>	14 <sup>5</sup> / <sub>16</sub> " 364 mm	13 <sup>11</sup> / <sub>16</sub> " 348 mm	7 <sup>7</sup> / <sub>16</sub> " 189 mm	10 <sup>5</sup> / <sub>16</sub> " 262 mm
<b>HLEMH / HLEMM / HLEMS / HLESX</b>	14 <sup>5</sup> / <sub>16</sub> " 405 mm	13 <sup>11</sup> / <sub>16</sub> " 383 mm	7 <sup>7</sup> / <sub>16</sub> " 224 mm	10 <sup>5</sup> / <sub>16</sub> " 303 mm

**WALL**

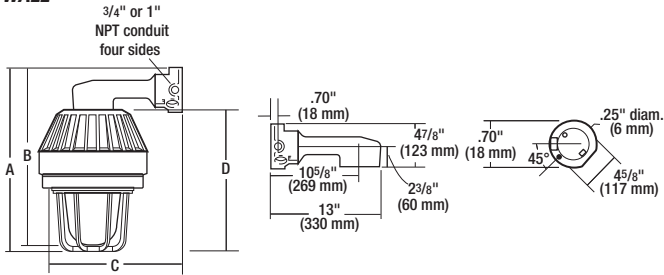

	<b>A</b>	<b>B</b>	<b>C</b>	<b>D</b>
<b>HLEMI / HLEBF</b>	15 <sup>13</sup> / <sub>16</sub> " 402 mm	14 <sup>7</sup> / <sub>16</sub> " 367 mm	14 <sup>1</sup> / <sub>2</sub> " 368 mm	10 <sup>5</sup> / <sub>16</sub> " 262 mm
<b>HLEMH / HLEMM / HLEMS / HLESX</b>	16 <sup>13</sup> / <sub>16</sub> " 427 mm	15 <sup>15</sup> / <sub>16</sub> " 405 mm	15" 381 mm	11 <sup>15</sup> / <sub>16</sub> " 303 mm

**STANCHION**

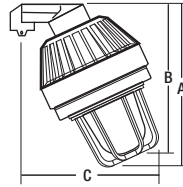

	<b>A</b>	<b>B</b>	<b>C</b>
<b>HLEMI / HLEBF</b>	14" 356 mm	13 <sup>1</sup> / <sub>4</sub> " 337 mm	13" 330 mm
<b>HLEMH / HLEMM / HLEMS / HLESX</b>	15 <sup>1</sup> / <sub>8</sub> " 384 mm	14" 356 mm	13 <sup>1</sup> / <sub>2</sub> " 343 mm

**STANDARD DOME REFLECTOR**

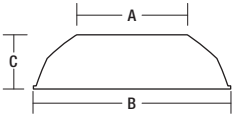

	<b>A</b>	<b>B</b>	<b>C</b>
<b>HLEMI / HLEBF</b>	7 <sup>3</sup> / <sub>8</sub> " 187 mm	14" 356 mm	3 <sup>3</sup> / <sub>4</sub> " 95 mm
<b>HLEMH / HLEMM / HLEMS</b>	8 <sup>3</sup> / <sub>4</sub> " 222 mm	16 <sup>1</sup> / <sub>8</sub> " 410 mm	3 <sup>15</sup> / <sub>16</sub> " 100 mm

**ANGLE DOME REFLECTOR**

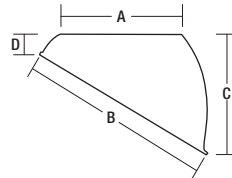

	<b>A</b>	<b>B</b>	<b>C</b>	<b>D</b>
<b>HLEMI / HLEBF</b>	7" 178 mm	11 <sup>1</sup> / <sub>2</sub> " 292 mm	7 <sup>3</sup> / <sub>4</sub> " 197 mm	1" 25 mm
<b>HLEMH / HLEMM / HLEMS</b>	8 <sup>3</sup> / <sub>4</sub> " 222 mm	14 <sup>3</sup> / <sub>16</sub> " 360 mm	7 <sup>3</sup> / <sub>4</sub> " 197 mm	1" 25 mm

TEMPERATURE CODES

**CLASS I, DIVISION 1 & 2 HLE SERIES HAZARDOUS LOCATION APPLICATION DATA**

FIXTURE SERIES <sup>1</sup>	LAMP TYPE/ SIZE MAX.	LAMP WATTS	RATED AMBIENT °C	SUPPLY WIRE SUITABLE FOR °C MIN.	CLASS I, DIV. 1 & 2 maximum surface temp w/o reflector		UL/CSA GROUPS	UL 595 LISTED <sup>2</sup>	PAINT SPRAY SUITABILITY (HOSE-DOWN) <sup>3</sup> UL	TYPE 4 (HOSE-DOWN) <sup>3</sup> UL
					TEMP I.D.	ACTUAL TEMP.				
HLEMI15	INC. A-19	60	40	75	T6	79	C, D	Yes	No	Yes
HLEMI15	INC. A-19	75	40	75	T4A	103	C, D	Yes	No	Yes
HLEMI15	INC. A-19	100	40	75	T4A	103	C, D	Yes	No	Yes
HLEMI15	INC. A-21	100	40	75	T4A	101	C, D	Yes	No	Yes
HLEMI15	INC. A-21	150	40	75	T4	123	C, D	Yes	No	Yes
HLEMI20	INC. A-23	100	40	90	T4A	107	C, D	Yes	No	Yes
HLEMI20	INC. A-23	150	40	90	T4	132	C, D	Yes	No	Yes
HLEMI20	INC. PS-25	150	40	90	T4	126	C, D	Yes	No	Yes
HLEMI20	INC. A-23	200	40	90	T3C	146	C, D	Yes	No	Yes
HLEMI20	INC. PS-25	200	40	90	T3C	154	C, D	Yes	No	Yes
HLEMI20	INC. PS-25	300	40	90	T3	190	C, D	Yes	No	Yes
HLEBF13	FL (1) PL	13	40	75	T6	62	C, D	No	Yes	Yes
HLEBF26	FL (2) PL	26	40	75	T6	62	C, D	No	Yes	Yes
HLEMS070	HPS S-62	70	40	75	T6	83	C, D	Yes	Yes	Yes
HLEMS100	HPS S-54	100	40	75	T5	99	C, D	Yes	No	Yes
HLEMS150	HPS S-55	150	40	75	T4A	119	C, D	Yes	No	Yes
HLEMH070	MH M-98	70	40	75	T5	95	C, D	Yes	Yes	Yes
HLEMH100	MH M-90	100	40	75	T4A	101	C, D	Yes	No	Yes

1 Do not install where marked operating temperature exceeds ignition temperature of hazardous atmosphere.

2 For UL 1598A Marine Outdoor and UL/CSA Type 4 Fixture Label, add suffix ML to fixture catalog number.

NOTE: Fixtures approved for mounting with lamp base up only.

**CLASS II, DIVISION 1 & 2 HLE SERIES HAZARDOUS LOCATION APPLICATION DATA**

FIXTURE SERIES <sup>1</sup>	LAMP TYPE/ SIZE MAX.	LAMP WATTS	RATED AMBIENT °C	SUPPLY WIRE SUITABLE FOR °C MIN.	CLASS II, DIV. 1 & 2 maximum surface temp		UL/CSA GROUPS	CLASS III DIV. 1 & 2 UL/CSA SUITABILITY		
					UL/CSA w/ Reflector TEMP I.D.	UL/CSA w/o Reflector TEMP I.D.				
HLEMI15	INC. A-19	60	40	75	T3C	132	T3C	132	E, F, G	Yes
HLEMI15	INC. A-19	75	40	75	T3A	163	T3A	162	E, F	No
HLEMI15	INC. A-19	100	40	75	T3A	163	T3A	162	E, F	No
HLEMI15	INC. A-21	100	40	75	T3A	172	T3A	172	E, F	No
HLEMI15	INC. A-21	150	40	75	N/A	192	T3	192	E, F	No
HLEMI20	INC. A-23	100	40	90	T3A	166	T3A	166	E, F	No
HLEMI20	INC. A-23	150	40	90	T3	196	T3A	178	E, F	No
HLEMI20	INC. PS-25	150	40	90	N/A	N/A	N/A	N/A	No	No
HLEMI20	INC. A-23	200	40	90	N/A	N/A	N/A	N/A	No	No
HLEMI20	INC. PS-25	200	40	90	N/A	N/A	N/A	N/A	No	No
HLEMI20	INC. PS-25	300	40	90	N/A	N/A	N/A	N/A	No	No
HLEBF13	FL (1) PL	13	40	75	T6	69	T6	66	E, F, G	Yes
HLEBF26	FL (2) PL <sup>2</sup>	26	40	75	T6	69	T6	66	E, F, G	Yes
HLEMS070	HPS S-62	70	40	75	T4A	116	T4A	116	E, F, G	Yes
HLEMS100	HPS S-54	100	40	75	T3B	161	T3B	161	E, F, G	Yes
HLEMS150	HPS S-55	150	40	75	T3B	180	T3B	180	E, F	No
HLEMH070	MH M-98	70	40	75	T4	121	T4	121	E, F, G	Yes
HLEMH100	MH M-90	100	40	75	T3C	150	T3C	153	E, F, G	Yes

1 Do not install where marked operating temperature exceeds ignition temperature of hazardous atmosphere.

2 13 watts per lamp.

NOTE: Fixtures approved for mounting with lamp base up only.

Due to our continued efforts to improve our products, product specifications are subject to change without notice.

---



**Industrial Lighting**

Hubbell Industrial Lighting • 701 Millennium Boulevard • Greenville, SC 29607 • PHONE: 864-678-1000  
For more information visit our web site: [www.hubbell-ltg.com](http://www.hubbell-ltg.com)