

KEMLUX® II KH SERIES

ENCLOSED/GASKETED

Cat. #		Approvals
Job	Type	



APPLICATIONS

- For use in corrosive, harsh, hazardous applications such as chemical, petrochemical, marine, power generation, pharmaceutical, or food processing plants.

SPECIFICATIONS

- Mogul base socket. Cover selection of rigid and flexible pendant, ceiling, wall and 25° stanchion in varying threaded NPT entries.
- Minimum starting temperature of -20°F for MV/MH and -40°F for HPS.
- Copper-free (<0.4%) aluminum housing, cover and guard with white Lektrocote® powder polyester paint finish.
- Optic choices of impact-resistant glass globe, symmetrical/asymmetrical glass refractors, dome/angle FRP reflector, 19" enclosed reflector, and polycarbonate enclosed low bay.
- Modular design permits selection of cover, body, globe, guard and reflector for custom applications.

LISTINGS

- UL 844 Standard: Class I, Division 2, Groups A, B, C, D; Class II, Div. 1 & 2, Groups E, F, G; Class III, Div. 1 & 2.
- UL 1598A Marine Outdoor, NEMA 4X with K-G globe; 40°C ambient listed; UL 1598 Wet Location.

medium housing

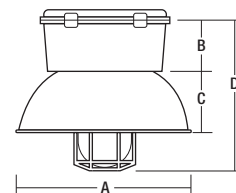

GLOBE (K-G), GUARD (K-10), DOME (K-06)

A	B	C	D
16 ³ / ₈ "	4 ³ / ₄ "	5 ⁵ / ₈ "	14 ¹ / ₂ "
416 mm	121 mm	143 mm	368 mm



MORE DIMENSIONS INSIDE

ORDERING INFORMATION

ORDERING EXAMPLE: KH-10S8-G-P2-F4

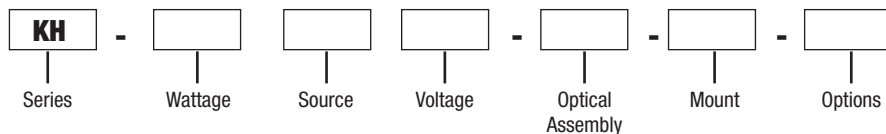

SERIES

KH Kemplux II® KH Series

WATTAGE

MEDIUM HOUSING

- 50** 50 watt HPS
- 70** 70 watt HPS, Pulse Start MH
- 10** 100 watt HPS, Pulse Start MH
- 15** 150 watt HPS, Pulse Start MH
- 17** 175 watt Pulse Start MH

LARGE HOUSING

- 25** 250 watt HPS Pulse Start MH¹
- 40** 400 watt HPS Pulse Start MH

SOURCE

- S** High Pressure Sodium (HPS)
- P** Pulse Start (Consult Factory)

VOLTAGE

- 1** 120V (50 watt HPS)
- 4** 277V (50 watt HPS only)
- 5** 480V (not available for 50 watt HPS)
- 6** Tri-Tap²
(120/277/347V)
- 8** Quad-Tap²
(120, 208, 240, 277V)
- E** 220/240V 50Hz
- F** 347V

OPTICAL ASSEMBLY

MEDIUM HOUSING

- G** Globe
- X** Reflector/Polycarbonate Refractor² (50-150W HPS)

MEDIUM OR LARGE HOUSING

- L** Symmetrical Glass Refractor
- LARGE HOUSING
- M** Asymmetrical Glass Refractor
- E** Enclosed Reflector

MOUNT

- C2** 3/4" Ceiling
- C3** 1" Ceiling
- D4** 1 1/4" Stanchion
- D5** 1 1/2" Stanchion
- P2** 3/4" Pendant
- P3** 1" Pendant
- W2** 3/4" Wall
- W3** 1" Wall

OPTIONS

- F(X)** Fusing (X indicates voltage)^{3,4}
- RS** Hot Restrike
(70-150 watt HPS only)
- UP** Unit Pack-mounting adapter, ballast housing; globe and/or guard in same carton (medium housing only); reflector shipped separately
- FA** Factory Assembled - lamp and globe installed onto housing; includes mounting adapter and/or guard (medium housing only); reflector shipped separately

¹ 250W MH with Tri-Tap® ballast requires deeper Electro-Reg® mounting adapter.
² Consult factory for use with 150W MH U.V. Guard Lamp.
³ To specify voltage, replace X with 1-120V, 2-208V, 3-240V, 4-277V, 5-480V, F-347.
⁴ Not offered with CSA listing.

ORDERING INFORMATION

KH SERIES MOUNTING ADAPTERS The following mounting adapters are available for the KH Series. Order separately or refer to Catalog Logic for complete fixture.

Catalog Number	Description	Hubs		Plugs Qty	Weight	
		Size	Qty		lbs.	kg
KH-P2	Pendant	3/4"	1	—	1.5	0.7
KH-P3	Pendant	1"	1	—	1.5	0.7
KH-C2	Ceiling	3/4"	4	3	2.0	0.9
KH-C3	Ceiling	1"	4	3	2.0	0.9
KH-D4	25° Stanchion	1 1/4"	1	—	4.0	1.8
KH-D5	25° Stanchion	1 1/2"	1	—	4.0	1.8
KH-W2	Wall	3/4"	4	3	4.0	1.8
KH-W3	Wall	1"	4	3	4.0	1.8

KH SERIES ACCESSORIES

Catalog Number	Description	Weight lbs.	kg
K-10	Cast Guard for K-G globe	1	0.5
K-20	Steel Wire Guard for K-L & K-M glass refractors (zinc plated)	2	0.9
K-30	Steel Wire Guard for K-E enclosed refractors (painted)	1	0.5
K-06	Standard Dome Reflector for K-G globe (FRP)	1	0.5
K-07	30° Angle Reflector for K-G globe (FRP)	1	0.5
K-SC6	6' Safety Chain (large housing only, order separately)	—	—

KH SERIES BALLAST HOUSING

Wattage	Voltage	Catalog Number	
		HPS	Pulse Start Metal Halide
50W	120	KH50S1	—
	277	KH50S4	—
70W	120/208/240/277	KH70S8	KH70H8
	480	KH70S5	KH70H5
100W	120/208/240/277	KH10S8	KH10H8
	480	KH10S5	KH10H5
150W	120/208/240/277	KH15S8	—
	480	KH15S5	—
175W	120/208/240/277	—	—
	480	—	—
250W	120/208/240/277	KH25S8	KH25P8
	480	KH25S5	KH25P5
400W	120/208/240/277	KH40S8	KH40P8
	480	KH40S5	KH40P5

KH SERIES OPTICS

Catalog Number	Description	Weight lbs.	kg
K-G	Prismatic, heat-resistant Glass Globe (medium housing only)	2	0.9
K-E	19" Enclosed Reflector	7	3.2
K-L	Symmetrical (Type V) Glass Refractor	13	5.9
K-M	Asymmetrical (Type II) Glass Refractor	13	5.9
K-X	Reflector/Polycarbonate Refractor (medium housing only)	—	—

TEMPERATURE RATINGS

CLASS I, DIVISION 2, CLASS II, DIVISION 1 & 2, CLASS III, DIVISION 1 & 2
K-E/K-30 ENCLOSED REFLECTOR/GUARD

CLASS I, DIVISION 2			CLASS II, DIV. 1 & 2 - CLASS III, DIV. 1 & 2			MAXIMUM AMBIENT °C
WATTAGE	TEMP RATING °C	T-CODE	GROUPS	TEMP RATING °C	T-CODE	
250W HPS	280	T2A	E, F, G	160	T3C	40
400W HPS	350 ¹	— ¹	E, F, G	160	T3C	40
400W MH	300	T2	E, F, G	160	T3C	40

¹ No T-Rating Code exists for 325°C or 350°C T-Ratings.

CLASS II, DIVISION 2, GROUP G
K-X POLYCARBONATE OPTIC

CLASS II, DIVISION 2 – GROUP G			MAXIMUM AMBIENT °C
WATTAGE	TEMP RATING °C	T-CODE	
50W HPS	85	T6	40
70W HPS	85	T6	40
100W HPS	85	T6	40
150W HPS	85	T6	40
150W MH (UV guard lamp)	85	T6	40

MORE T-RATINGS ON BACK

DIMENSIONS

medium housing

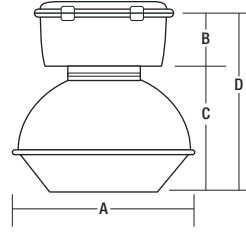
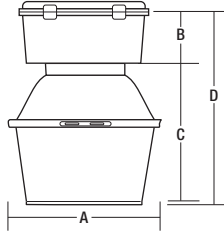
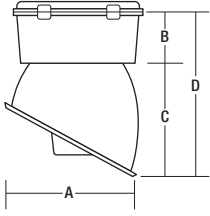

GLOBE (K-G), ANGLE DOME (K-07)

A	B	C	D
11 ¹ / ₄ "	4 ³ / ₄ "	10 ¹ / ₄ "	15"
286 mm	121 mm	260 mm	381 mm

GLASS REFRACTOR (K-L)

A	B	C	D
12 ¹ / ₄ "	4 ³ / ₄ "	13 ⁵ / ₁₆ "	18 ⁷ / ₁₆ "
311 mm	121 mm	338 mm	468 mm

REFLECTOR/POLYCARBONATE REFRACTOR (K-X)

A	B	C	D
16"	4 ³ / ₄ "	11 ¹ / ₂ "	16 ¹ / ₄ "
406 mm	121 mm	292 mm	413 mm

large housing

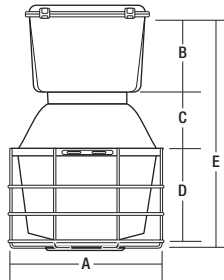
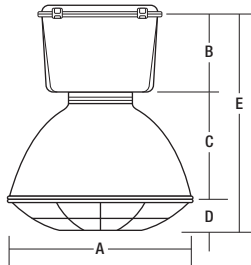

ENCLOSED REFRACTOR (K-E), GUARD (K-30)

A	B	C	D	E
19"	6 ¹ / ₁₆ "	12 ⁵ / ₈ "	3 ¹ / ₂ "	22 ¹ / ₄ "
483 mm	154 mm	321 mm	89 mm	565 mm

REFRACTOR (K-L, K-M), GUARD

A	B	C	D	E
13 ¹ / ₄ "	6 ¹ / ₁₆ "	5 ³ / ₄ "	7 ⁹ / ₁₆ "	19 ³ / ₄ "
337 mm	154 mm	146 mm	192 mm	502 mm

mounting adapters

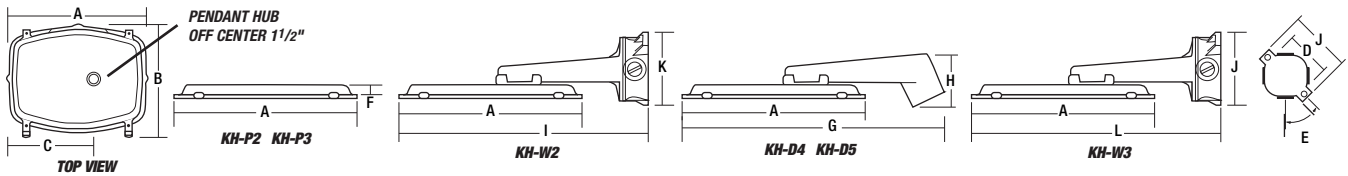

A	B	C	D	E	F	G	H	I	J	K	L
12 ¹ / ₄ "	10"	7 ¹ / ₁₆ "	5 ⁵ / ₈ "	45°	2 ³ / ₁₆ "	17 ¹ / ₈ "	3 ¹ / ₂ "	16 ¹ / ₂ "	5"	4 ⁷ / ₁₆ "	17 ¹ / ₈ "
311 mm	254 mm	179 mm	143 mm	-	56 mm	435 mm	89 mm	419 mm	127 mm	113 mm	435 mm

TEMPERATURE RATINGS

CLASS I, DIVISION 2, CLASS II, DIVISION 1 & 2, CLASS III, DIVISION 1 & 2
K-G/K-10/K-06/K-07 GLASS GLOBE AND GUARD INCLUDING ANGLE AND DOME

CLASS I, DIVISION 2			CLASS II, DIV. 1 & 2 - CLASS III, DIV. 1 & 2			MAXIMUM AMBIENT °C
WATTAGE	TEMP RATING °C	T-CODE	GROUPS	TEMP RATING °C	T-CODE	
HIGH PRESSURE SODIUM						
50W	165	T3B	E, F, G	135	T4	40
70W	165	T3B	E, F, G	135	T4	40
100W	215	T2D	E, F, G	135	T4	40
150W	260	T2B	E, F, G	160	T3C	40
PULSE START METAL HALIDE						
70W	180	T3A	E, F, G	120	T4A	40
100W	200	T3	E, F, G	160	T3C	40
175W	260	T2B	E, F (K-06) E, F, G (K-07)	200 160	T3 (K-06) T3C (K-07)	40
250W ¹	300	T2	—	—	—	40
250W ²	400 ³	T1 ³	—	—	—	40

¹ Ceiling, pendant, wall bracket mounting.
² Davit mount only.
³ Actual T-Rating range does not exceed 400°C.

CLASS I, DIVISION 2, CLASS II, DIVISION 1 & 2, CLASS III, DIVISION 1 & 2
K-L/K-20 GLASS REFRACTOR AND GUARD, K-M/K-20 GLASS REFRACTOR AND GUARD

CLASS I, DIVISION 2			CLASS II, DIV. 1 & 2 - CLASS III, DIV. 1 & 2			MAXIMUM AMBIENT °C
WATTAGE	TEMP RATING °C	T-CODE	GROUPS	TEMP RATING °C	T-CODE	
HIGH PRESSURE SODIUM						
50W	180	T3A	E, F, G	160	T3C	40
70W	180	T3A	E, F, G	160	T3C	40
100W	200	T3	E, F, G	160	T3C	40
150W	230	T2C	E, F, G	160	T3C	40
250W	280	T2A	E, F, G	160	T3C	40
400W	350 ¹	— ¹	E, F, G	160	T3C	40
METAL HALIDE						
70W	165	T3B	E, F, G	120	T4A	40
100W	200	T3	E, F, G	160	T3C	40
175W	260	T2B	E, F, G	160	T3C	40
250W	300	T2	E, F, G	160	T3C	40
400W	300	T2	E, F, G	180	T3A	40

¹ No T-Rating Code exists for 325°C or 350°C T-Ratings.

Due to our continued efforts to improve our products, product specifications are subject to change without notice.



Industrial Lighting

Hubbell Industrial Lighting • 701 Millennium Boulevard • Greenville, SC 29607 • PHONE: 864-678-1000
 For more information visit our web site: www.hubbell-ltg.com