

TRIBAY® EU/OU SERIES

19" SPUN ALUMINUM
REFLECTOR

Cat. #		Approvals
Job	Type	



APPLICATIONS

- Low to medium mounting heights.

SPECIFICATIONS

- CH-EU Series enclosed & gasketed.
- CH-OU Series open, flow-through design.
- Heavy-duty, die cast Lektrocote® aluminum ballast housing stands up to the toughest environments for years of maintenance-free industrial service.
- Optically superior 19" Anodal® finished aluminum reflector.
- Extended thermal certification (65°C) assures long service life for ballast and electrical components.
- Optional Quick-Zone® electrical disconnect sets a new convenience standard for installation and maintenance.

LISTINGS

- EU suitable for wet locations.
- OU suitable for damp locations
- 250 to 400W requires minimum 90°C supply wire.
- 400W plus to 750W requires minimum 105°C supply wires.

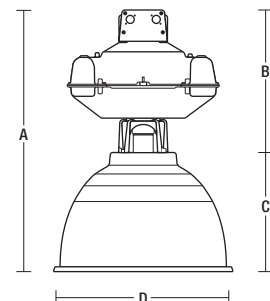

A	B	C	D
27 ⁷ / ₈ "	15 ³ / ₁₆ "	12 ⁷ / ₈ "	19"
708 mm	386 mm	327 mm	483 mm

ORDERING INFORMATION

ORDERING EXAMPLE: CH-40P8-M-OU

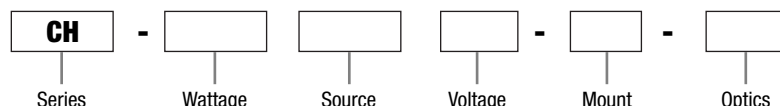

SERIES

CH Tribay®

WATTAGE

25	250 watt, Pulse Start MH, HPS
32	320 watt Pulse Start MH only
35	350 watt Pulse Start MH
40	400 watt, Pulse Start MH, HPS
45	450 watt Pulse Start MH only
75	750 watt Pulse Start MH only ²

SOURCE

S	Standard CWA, AL, HPS
F	HPS, CWI (Canada)
D	MH, CWI (Canada)
P	Pulse Start MH

¹ Single voltage designations for isolated secondary ballast only.

² 55°C standard, for 65°C use -HA option.
NOTE: Bottom enclosures are required unless lamps designated as "suitable for open use" are used.

NOTE: Options must be added as suffix to Catalog Number. Accessories must be ordered separately.

VOLTAGE

1	120V ¹
2	208V ¹
3	240V ¹
4	277V ¹
5	480V ¹
6	Tri-Tap® 120/277/347V
7	600V (isolated secondary only)
8	Quad-Tap® 120/208/240/277V
O	Less Ballast & Cap (250 & 400W only)
E	220/240V 50 Hz
F	347V ¹

MOUNT

D	Quick Zone™ Electrical Disconnect wiring box shipped w/ fixture
E	Quick Zone™ Electrical Disconnect wiring box not shipped w/ fixture (box shipped as accessory -CH-Q)
L	Less Wiring Box (box shipped as accessory -CH-B)
M	With Wiring Box (standard const.)

OPTICS

EU	19" Enclosed Highbay Reflector (wet location)
OU	19" Open Highbay Reflector (damp location)
NA	No Optics, enclosed highbay
NB	No Optics, open highbay

ACCESSORIES

Order separately

Catalog Number	Description
CH-B	Wiring Box with no electrical disconnect
CH-Q	Wiring Box with electrical disconnect (Quick-Zone®)
CH-ENC-19	Tempered Glass Lens Door for open 19"
CH-LLR	Lower Luminaire Retainer (for field installation)
WG-19	Wire Guard for 19" highbay reflectors
CH-TLR6	6' Top Luminaire Retainer (for field installation)
CH-TLR10	10' Top Luminaire Retainer (for field installation)
CH-TLR12	12' Top Luminaire Retainer (for field installation)
CH-TLR16	16' Top Luminaire Retainer (for field installation)
CH-F	Single Fuse Kit - 120, 277, 347V (fuses not included)
CH-FF	Double Fuse Kit - 208, 240, 480V (fuses not incl.) (not for Canada)

BOTTOM ENCLOSURE

CH-ENC-19 Bottom Enclosure (OU only)

OPTIONS FOR TRIBAY SERIES

Factory installed — order with fixture by adding suffix

Suffix	Description
-AN	Anodized Housing/Reflector
-CFB	Charcoal Filter Breather (for enclosed reflectors only)
-C4HL	4' Cord, Hook/Loop - SO cord wired thru hook
-C6HL	6' Cord, Hook/Loop - SO cord wired thru hook
-C8HL	8' Cord, Hook/Loop - SO cord wired thru hook
-C10HL	10' Cord, Hook/Loop - SO cord wired thru hook
-C12HL	12' Cord, Hook/Loop - SO cord wired thru hook

CORD, HOOK/LOOP & 20A PLUG - SO CORD W/ PLUG WIRED THRU HOOK

	LENGTH	X=	120V	208V	240V	277V	480V	347V
-C4HLP (X)	4'		1	2	3	4	5	C
-C6HLP (X)	6'		1	2	3	4	5	C
-C8HLP (X)	8'		1	2	3	4	5	C
-C10HLP (X)	10'		1	2	3	4	5	C
-C12HLP (X)	12'		1	2	3	4	5	C

CORD, HOOK/LOOP & 15A 120V PLUG - SO CORD W/ PLUG WIRED THRU HOOK

	LENGTH	X=	120V	208V	240V	277V	480V	347V
-C4HLPX-15A	4'		1	2	3	4	5	C
-C6HLPX-15A	6'		1	2	3	4	5	C
-C8HLPX-15A	8'		1	2	3	4	5	C
-C10HLPX-15A	10'		1	2	3	4	5	C
-C12HLPX-15A	12'		1	2	3	4	5	C

Suffix	Description
-DS	Intelligent Ignitor External Replacement Ignitor
-EM	Emergency Quartz Lamp Socket
-EX	Exclusionary Mogul Socket
-F1	Fusing 120 volt
-F2	Fusing 208 volt (not for Canada)
-F3	Fusing 240 volt (not for Canada)
-F4	Fusing 277 volt
-F5	Fusing 480 volt (not for Canada)
-FF	Fusing 347 volt
-FF	Fusing 347 volt
-LL	Shipped Less Lamp (250, 350, 400 watt MH Electro-Reg® and 600 watt HPS only)
-LRI	Lower Luminaire Retainer (installed)
-PC	Polycarbonate Refractor (LM only)
-QSS	Quartz Standby
-QST	Quartz Standby with time delay
-SLD-1	Switch Level Dimming with 120V control
-SLD-2	Switch Level Dimming with 24V control
-SLD-3	Switch Level Dimming with 277V control
-TRI(6)	6' Top Luminaire Retainer (installed)
-TRI(10)	10' Top Luminaire Retainer (installed)
-TRI(12)	12' Top Luminaire Retainer (installed)
-TRI(16)	16' Top Luminaire Retainer (installed)

TRIBAY® EU/OU For complete spacing-to-mounting height ratios, visit our web site at www.hubbell-ltg.com

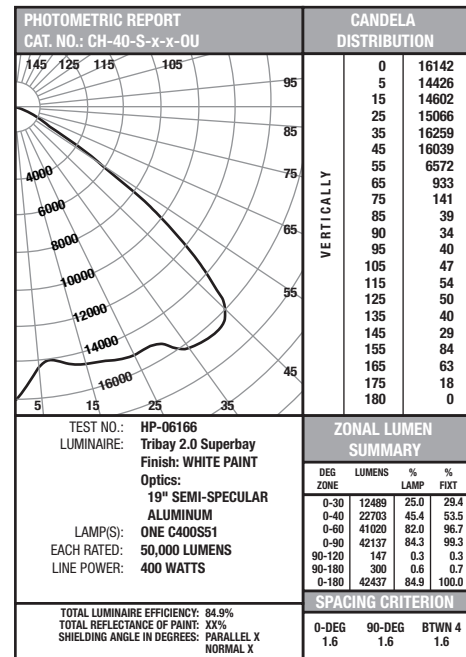
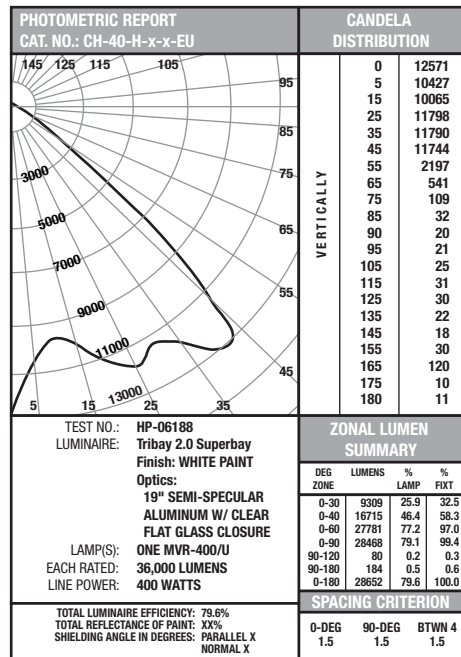
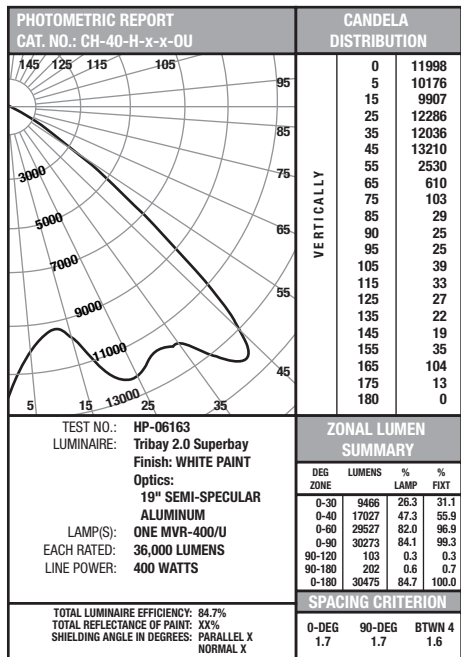

COEFFICIENTS OF UTILIZATION - ZONAL CAVITY METHOD
EFFECTIVE FLOOR CAVITY REFLECTANCE 0.20

RC	0	10	20	30	40	50	60	70	80	90	100	
0	70	50	30	10	70	50	30	10	50	30	10	0
1	101	101	101	101	98	98	98	98	94	94	90	90
2	89	84	80	77	87	83	79	76	80	77	74	69
3	84	77	72	68	82	76	71	68	74	70	67	63
4	78	70	64	60	76	69	64	60	67	63	59	56
5	72	64	58	53	71	63	57	53	61	56	52	50
6	67	58	52	47	66	57	51	47	56	51	47	44
7	62	52	46	41	61	52	46	41	50	45	41	39
8	57	47	41	36	56	46	40	36	45	40	36	34
9	52	42	35	31	51	41	35	31	39	34	31	29
10	46	35	29	25	45	35	29	25	34	28	24	23

COEFFICIENTS OF UTILIZATION - ZONAL CAVITY METHOD
EFFECTIVE FLOOR CAVITY REFLECTANCE 0.20

RC	0	10	20	30	40	50	60	70	80	90	100	
0	70	50	30	10	70	50	30	10	50	30	10	0
1	95	95	95	95	92	92	92	92	88	88	84	84
2	84	79	74	73	82	78	75	72	75	72	70	67
3	79	73	68	65	77	72	68	64	70	66	63	60
4	74	66	61	57	72	65	61	57	64	59	56	53
5	69	61	55	51	67	60	55	51	58	54	50	48
6	64	55	49	45	62	54	49	45	53	48	45	43
7	59	50	44	40	58	49	44	40	48	43	40	38
8	54	45	39	35	53	44	39	35	43	38	35	33
9	50	40	34	30	49	40	34	30	39	34	30	28
10	44	34	28	24	43	34	28	24	33	28	24	22

COEFFICIENTS OF UTILIZATION - ZONAL CAVITY METHOD
EFFECTIVE FLOOR CAVITY REFLECTANCE 0.20

RC	0	10	20	30	40	50	60	70	80	90	100	
0	70	50	30	10	70	50	30	10	50	30	10	0
1	101	101	101	101	98	98	98	98	94	94	90	90
2	89	84	80	77	87	83	79	76	80	77	74	69
3	84	77	72	68	82	76	71	67	73	69	66	62
4	78	69	63	59	75	68	63	59	66	61	58	55
5	72	63	56	52	70	62	56	52	60	55	51	48
6	66	57	50	46	65	56	50	45	54	49	45	43
7	61	51	44	40	60	50	44	40	48	43	39	37
8	56	46	39	34	55	45	39	34	44	38	34	32
9	51	41	34	30	50	40	34	30	38	33	29	28
10	46	35	29	24	45	34	28	24	34	28	24	22

QUICK ESTIMATOR CH-OU

LAMP QTY-LU/LP INPUT WATTS	SC @2/@4 LLF TEST #	ROOM WIDTH -/- MOUNTING HEIGHT (above floor)	ILLUMINANCE (MAINTAINED) APPROXIMATE AREA PER LUMINAIRE (SQ. FT.) / APPROXIMATE WATTS PER SQ. FT. (w/Blst. Losses)				
			10 fc	20 fc	50 fc	75 fc	100 fc
			MS250/BU/PS (ENC) 1 @ 23800 292	2.0/1.7 0.57 HP-06476	5 or more 2 1	1075 / 0.27 830 / 0.35 613 / 0.48	538 / 0.54 415 / 0.70 306 / 0.95
MS400/BU/PS 1 @ 44000 452	1.7/1.6 0.60 HP-06163	5 or more 2 1	2265 / 0.20 1764 / 0.26 1317 / 0.34	1132 / 0.40 882 / 0.51 658 / 0.69	453 / 1.00 353 / 1.28 263 / 1.72	302 / 1.50 235 / 1.92 176 / 2.57	226 / 2.00 176 / 2.56 132 / 3.43
MH400/U 1 @ 36000 458	1.7/1.6 0.57 HP-06163	5 or more 2 1	1774 / 0.26 1382 / 0.33 1031 / 0.44	887 / 0.52 691 / 0.66 516 / 0.89	355 / 1.29 276 / 1.66 206 / 2.22	236 / 1.94 184 / 2.49 137 / 3.33	177 / 2.58 138 / 3.31 103 / 4.44

QUICK ESTIMATOR CH-EU

LAMP QTY-LU/LP INPUT WATTS	SC @2/@4 LLF TEST #	ROOM WIDTH -/- MOUNTING HEIGHT (above floor)	ILLUMINANCE (MAINTAINED) APPROXIMATE AREA PER LUMINAIRE (SQ. FT.) / APPROXIMATE WATTS PER SQ. FT. (w/Blst. Losses)				
			10 fc	20 fc	50 fc	75 fc	100 fc
			MS250/BU/PS 1 @ 23800 292	1.9/1.6 0.59 HP-06467	5 or more 2 1	1128 / 0.26 877 / 0.33 655 / 0.45	564 / 0.52 439 / 0.67 327 / 0.89
MS400/BU/PS 1 @ 44000 452	1.5/1.5 0.59 HP-06188	5 or more 2 1	2086 / 0.22 1648 / 0.27 1236 / 0.37	1043 / 0.43 824 / 0.55 618 / 0.73	417 / 1.08 330 / 1.37 247 / 1.83	278 / 1.63 220 / 2.06 165 / 2.74	209 / 2.17 165 / 2.74 124 / 3.66
MH400/U 1 @ 36000 458	1.5/1.5 0.56 HP-06188	5 or more 2 1	1633 / 0.28 1291 / 0.35 968 / 0.47	817 / 0.56 645 / 0.71 484 / 0.95	327 / 1.40 258 / 1.77 194 / 2.37	218 / 2.10 172 / 2.66 129 / 3.55	163 / 2.80 129 / 3.55 97 / 4.73

To determine the number of luminaires required for a given illuminance level:

Step 1: Determine room size per column three below as 5 or more (Large Room), 2 (Medium Room) or 1 (Small Room).

Step 2: For desired footcandle level, per room size, divide floor area of space by "Approximate Area per Luminaire" from chart.

Step 3: If required, adjust result of Step 2 to "whole number." Result is quantity of luminaires required to provide approximate, average maintained illuminance selected.

Due to our continued efforts to improve our products, product specifications are subject to change without notice.



Industrial Lighting

Hubbell Industrial Lighting • 701 Millennium Boulevard • Greenville, SC 29607 • PHONE: 864-678-1000
For more information visit our web site: www.hubbell-ltg.com